

# 2-way ball valves for manifold mounting

Steel · DN 6 - DN 65

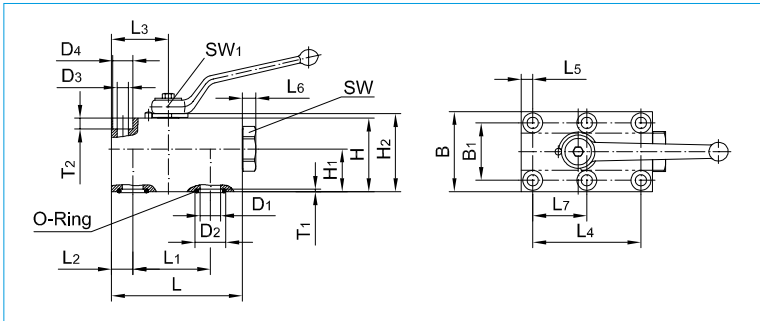

Handle and o-rings included in delivery  
 For handle refer to "Attachments, accessories"  
 Custom orders on request  
 All dimensions subject to change without notice  
 \*) DN 32 to DN 50: grey cast iron

Dimensions in mm  
 Weight in kg  
 Pressure in bar

Body*:	steel	steel
Ball:	steel, hard chrome plated	steel, hard chrome plated
Stem:	steel	steel
Body seals:	NBR	FKM
Ball seats:	POM	POM
Stem seals:	NBR	FKM

Connection	DN	L	L1	L2	L3	L4	L5	L6	L7	B	B1	H	H1	H2	T1	T2
Body-Flange with O-ring-seal	6	59	35	8,5	23,5	35	8,5	4,5	17,5	40	27	35	20,0	37,5	1,8	6,8
	10	73	44	10,0	29,0	55	7,5	7,0	27,5	55	40	45	24,5	48,5	1,8	8,0
	12	98	58	16,0	42,5	83	7,5	10,0	41,5	60	45	55	32,0	58,5	1,8	8,0
	20	117	69	20,0	52,0	97	10,0	12,0	48,5	70	51	70	39,0	74,0	2,7	11,0
	25	138	81	24,0	62,0	115	10,0	7,0	57,5	80	60	80	46,0	84,0	2,7	11,0
	32	165	96	29,0	75,0	136	12,0	11,0	68,0	100	78	100	56,6	104,5	2,7	12,0
	40	175	112	28,5	84,5	112	28,5	25,0	56,0	130	95	100	52,6	104,5	2,7	17,5
	50	215	136	38,0	106,0	136	38,0	25,0	68,0	150	112	110	55,1	114,5	2,7	20,0
65	320	190	55,0	150,0	210	45,0	63,0	105,0	235	185	157	78,5	161,5	2,8	25,5	

DN	D1	D2	D3	D4	SW	SW1	Handle Code	Weight	For cylinder-head screw DIN EN ISO 4762 (DIN 912)
6	6,0	12,0	6,4	11	24	7	1	0,58	M6 - 10,9
10	9,5	15,0	8,4	-	32	8	2	1,17	M8 - 10,9
12	12,5	25,0	8,4	-	36	10	3	2,25	M8 - 12,9
20	20,0	30,0	10,5	17	-	14	53	4,00	M10 - 12,9
25	24,0	35,0	10,5	17	50	14	53	5,82	M10 - 12,9
32	32,0	40,0	13,0	19	70	17	22	10,97	M12 - 12,9
40	38,0	48,5	17,0	26	-	17	22	15,25	M16 - 12,9
50	48,0	55,5	21,0	33	-	17	22	23,20	M20 - 12,9
65	62,0	79,0	26,0	40	-	22	11	88,00	M24 - 12,9

PN	Article-No.	PN	Article-No.
500	106 021	500	106 031
500	106 022	500	106 032
500	106 023	500	106 033
400	106 024	400	106 034
400	106 025	400	106 035
400	106 026	400	106 036
400	106 027	400	106 037
400	106 028	400	106 038
400	106 029**	400	106 039**

\*\*\*) also available with bypass, dimensions on request

DN	D1	E1	E2	E3	E4	E5	E6	E7	E8	M	O-Ring
6	6,0	35	35,0	50,5	0,0	8,5	13,5	20,0	17,5	M6	7,50 x 2,50
10	9,5	44	52,5	63,0	2,5	10,0	20,0	27,5	25,0	M8	10,50 x 2,50
12	15,5	58	74,5	82,0	8,5	16,0	22,5	30,0	33,0	M8	20,50 x 2,50
20	20,0	69	87,0	97,0	10,0	20,0	25,5	35,0	38,5	M10	23,50 x 3,50
25	24,0	81	101,0	114,0	14,0	24,0	30,0	40,0	43,5	M10	28,50 x 3,50
32	32,0	96	119,0	136,0	17,0	29,0	39,0	50,0	51,0	M12	33,50 x 3,50
40	38,0	112	112,0	146,5	0,0	28,5	47,5	65,0	56,0	M16	42,00 x 3,50
50	48,0	136	136,0	177,0	0,0	38,0	56,0	75,0	68,0	M20	49,00 x 3,50
65	62,0	190	200,0	265,0	10,0	55,0	92,5	117,5	95,0	M24	72,66 x 3,53

General tolerances  
 DIN ISO 2768  
 Surfaces  
 DIN EN ISO 4287

## Drilling pattern

