

NAMUR
MOUNTED

powerite
division of Kinetrol Ltd

pneumatrol
A ROSS CONTROLS Company

Type J15, 'P' Series Pilot Valve



DESCRIPTION

Pilot valve designed for direct mounting onto 1/4 turn pneumatically operated valve actuators meeting 'NAMUR' standard fixing dimensions.

Body material available in

- Aluminium (standard)
- Stainless Steel
- Brass

Seal kit available – VSKC15P

FEATURES

- Top face air connection
- 1/4" BSP mains air connection and 1/8" BSP exhaust ports, also available in NPT ports
- Integrated Exhaust to Spring (ETS) feature in 3/2 position
- Single pilot spring return function or double pilot stay put function
- The valve is fitted with a changeover plate that allows the valve to be converted from 3/2 to 5/2 function quickly and easily for spring return and double acting actuators

PRODUCT CODE: **J 1 5** **P 0 0 0 0 0**

OPERATOR OPTIONS

SEE BELOW FOR
PRODUCT CODE
DETAILS

Any of the below options that are not required enter '0' in relevant box.

Operator

- | | | |
|--------------------------|--------------------------|--|
| <input type="checkbox"/> | <input type="checkbox"/> | Spring return, external pilot air connection |
| <input type="checkbox"/> | <input type="checkbox"/> | Double solenoid, external pilot air connection |

Options

- | | |
|--------------------------|--|
| <input type="checkbox"/> | Valve body brass |
| <input type="checkbox"/> | Valve body brass and NPT ports |
| <input type="checkbox"/> | NPT ports |
| <input type="checkbox"/> | Valve body stainless steel and NPT ports |
| <input type="checkbox"/> | Valve body stainless steel |
| <input type="checkbox"/> | Valve suitable for use with Oxygen |

EXHAUST TO SPRING

In 3/2 function a proportion of clean air exhausting from the actuator is fed back into the spring chamber.

DIMENSIONS (mm)

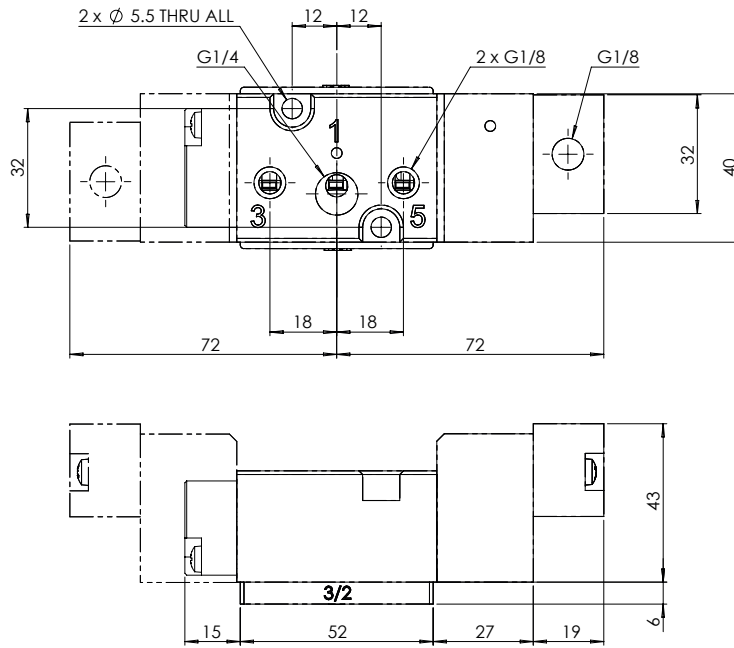

MATERIAL SPECIFICATIONS

	STANDARD
Body and End Caps	Black Anodised Aluminium (Dural)
Spool	Hard Anodised Aluminium PTFE Impregnated
Spacers	Glass Filled Acetal
Seals	Nitrile
Spring	Music Wire
Mounting Screws	Stainless Steel
Change Over Plate	Nylon 66 30% Glass Filled
Gasket	Nitrile

VALVE SPECIFICATIONS

	STANDARD
Port Connection Size	1/4" BSP
Pilot Port Connection Size	1/8" BSP
Working Pressure	3 to 10 bar
Pilot Signal Pressure	3 to 10 bar
Cv Factor	0.7
Flow Rate (at 6 bar with 1 bar pressure drop)	675 l/min
Maximum Ambient Temperature	+80 °C
Minimum Working Temperature	-20 °C

Official Stockist:

Powerite - Division of Kinetrol Ltd, Steelpark Trading Estate, Steelpark Way, Wolverhampton, WV11 3BF
Tel: 01902 780700 Email: enquiries@powerite.co.uk www.powerite.co.uk

Iss 1.4