

# Kinetrol Model T-CRD CR Dashpot

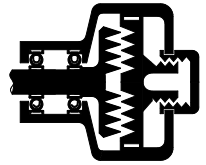

## Rates

Adjustable - see curves ( $\pm 10\%$ )

Adjustment allows the rate to be varied down to  $\frac{1}{4}$  of the maximum values, for any speed of rotation.

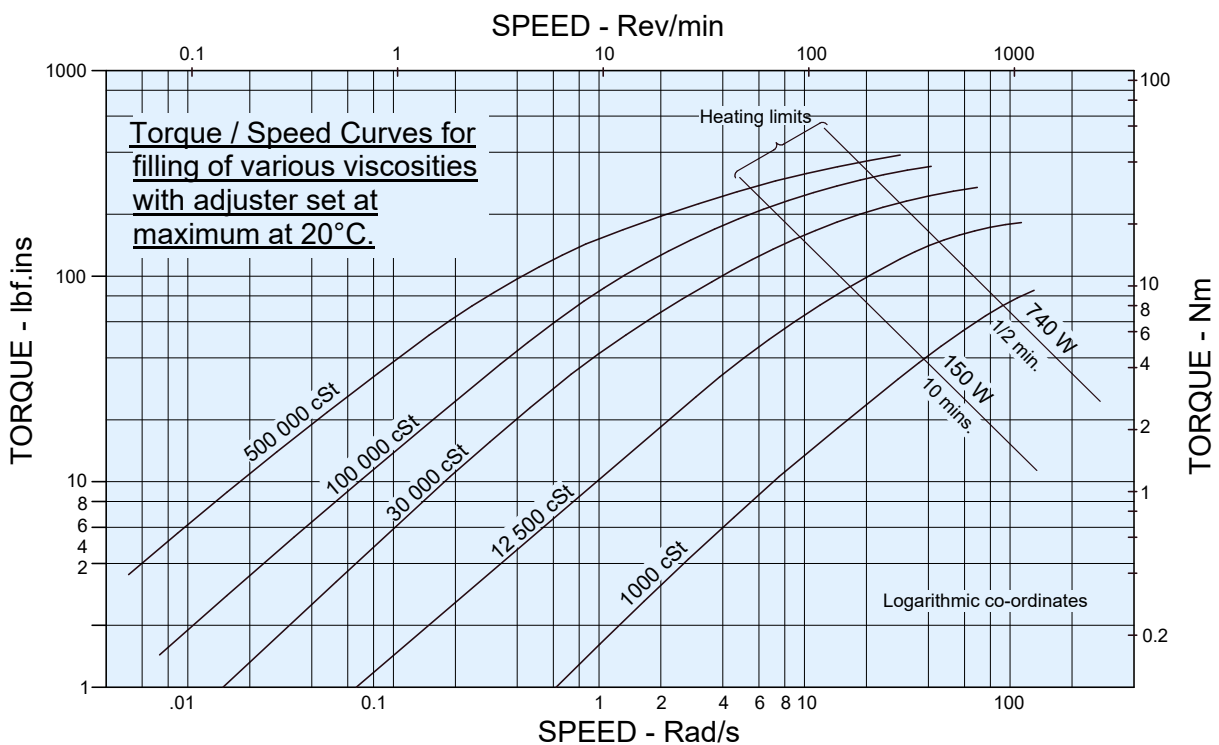

## Viscosities Available

1,000; 12,500; 30,000; 100,000; 500,000 cSt.

Specification of fluid viscosity provides torque/speed characteristics shown by the curves above.

## Ordering Codes

T – CRD – (Filling Viscosity)

**Example:**

T – CRD – 100,000 has a 100,000 cSt filling.

# Kinetrol Model T-CRD CR Dashpot

## Specification

**Max. safe torque**  
45 Nm / 398 lbf.ins

**Max. shaft side load**  
183 N / 41 lbf

**Ambient temperature range**  
0°C to 60°C (32°F to 140°F)

**Frictional torque**  
0.056 Nm / 0.5 lbf.ins typical

**Shaft material**  
High tensile steel 605M36(T)

**Body material**  
Cast Aluminium LM 4M

**Weight**  
2.39 kg / 5.27 lbs

## Dimensions

Dimensions in mm.

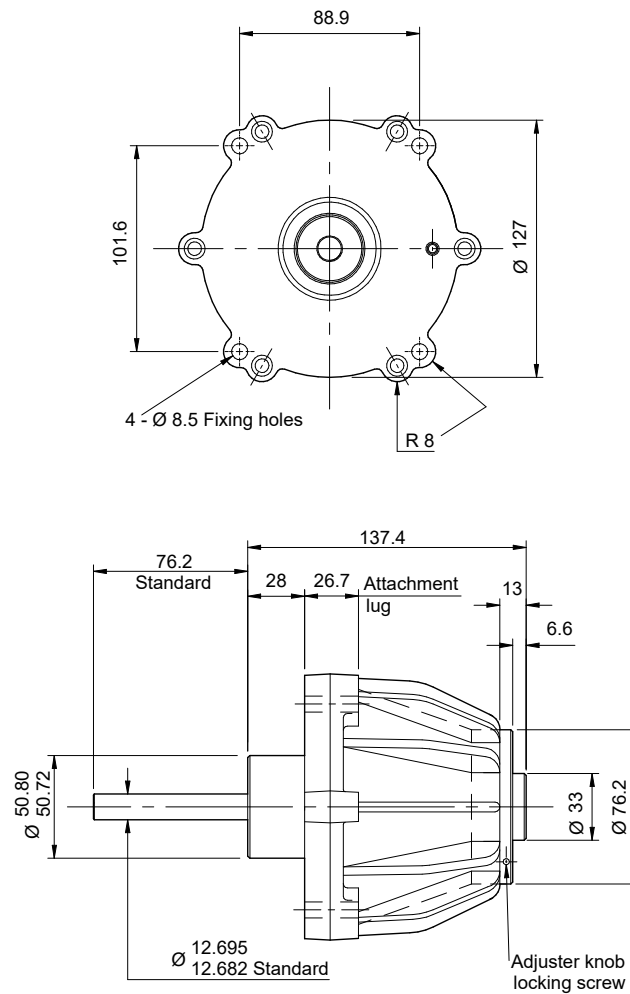

The adjuster knob, although marked for reference, is not normally calibrated.

Fixed rate version available - contact Kinetrol