

# Kinetrol Model LE 220° Vane Dashpot



## Rates

An adjuster permits any damping rate to be obtained within one of the following ranges. The range must be specified when ordering the dashpot.

- **LE1:** 50 to 350 Nm/rad/s / 443 to 3100 lbf.ins/rad/s
- **LE2:** 100 to 700 Nm/rad/s / 885 to 6200 lbf.ins/rad/s
- **LE3:** 200 to 1500 Nm/rad/s / 1770 to 13275 lbf.ins/rad/s
- **LE4:** 400 to 3000 Nm/rad/s / 3540 to 26550 lbf.ins/rad/s
- **LE5:** 800 to 6000 Nm/rad/s / 7080 to 53100 lbf.ins/rad/s
- **LE6:** 1600 to 12000 Nm/rad/s / 14160 to 106200 lbf.ins/rad/s

With adjuster set to maximum the rate may exceed stated maximum and with adjuster set to minimum the rate may be less than stated minimum.

## Options

The following features may be specified for any model:

### Differential Rate (FC or FAC)

Gives a large resistance in one direction only and less than 1/10 resistance in the other. Specify free clockwise or free anticlockwise when viewed from shaft end.

### Double Damping (DD)

Gives equal resistance in either direction.

### Couplings

Steel couplings are available as an option.

## Ordering Codes

LE1, 2, 3, 4, 5 or 6 – DD  
LE1, 2, 3, 4, 5 or 6 – FC or FAC

## Specification

### Max. safe torque

545 Nm / 4820 lbf.ins

Continuous power dissipation not to exceed 200W at 20°C (68°F)

### Angle of travel

220° ± 1°

External end stops must be provided

### Max. shaft end load

1000 N / 224 lbf pushing on shaft  
80 N / 18 lbf pulling on shaft

### Max. shaft side load

1500 N / 340 lbf

### Ambient temperature range

0°C to 60°C (32°F to 140°F)

### Frictional torque

3 Nm / 27 lbf.ins typical

### Shaft material

Stainless steel 431S29

### Body material

Aluminium alloy LM25

### Weight

12 kg / 26 lbs

# Kinetrol Model LE 220° Vane Dashpot

## Dimensions

Dimensions in mm

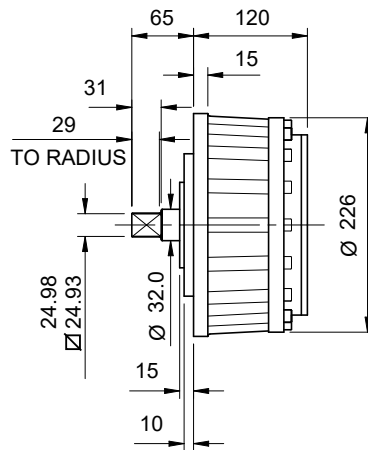
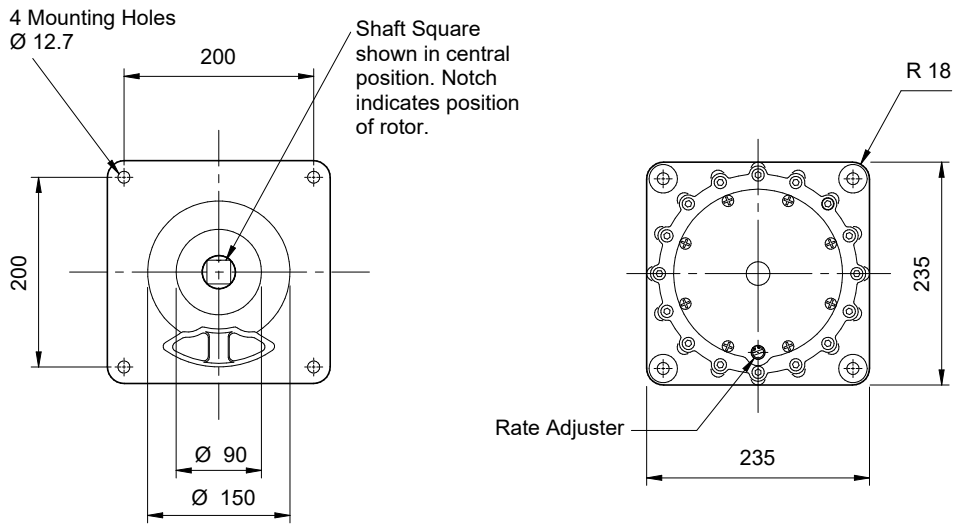

### STANDARD COUPLING

