

Kinetrol Control Units & Top-Mount Accessories

Modular Add-On Control Units

Kinetrol modular concept easily provides the control assembly needed

(Please see separate data sheets for individual items)

1. Visual Indicator

Gives visual indication of valve position as standard except models 0M0, 01, 16, 18, 21, 30 and 60.

2. Clear Cone Monitor

Gives 360° and overhead position indication. Available on actuator models 03, 05, 07, 08, 09, 10, 12, 14, 15, limit switch boxes, AP positioners, EL positioners, P3 positioners and EHD models.

3. I/P Controller

4-20mA electrical signal controls main air supply to pneumatic positioner as alternative to air signal control.

4. AP Positioner

3-15psi (0.2-1 bar) air signal controls main air supply to turn, stop or hold the actuator vane in proportional response to that air signal. Limit switch and angle retransmit options available.

5. EL Electropneumatic Positioner

A single unit gives smooth accurate control in response to a 4-20mA signal. Limit switch and angle retransmit options in same housing.

6. DP3 Positioner

3 Position operation or 4-20mA modulation, fast, smooth, precise control and resilient to poorer quality air. Simple set up, quick calibration and loop powered angle retransmit as standard.

7. Explosion Proof P3 On/Off Positioner

Provides the same basic options as the P3 Positioner but in a flame proof enclosure with ATEX approval.

8. VLS/ULS Limit Switch Box

Weathertight unit with up to 4 switches for remote position indication or control use. Optional switches for flame proof/explosion proof needs and high visibility Clear Cone monitor.

9. Explosion Proof Limit Switch Box

Provides the same basic options as the VLS/ULS Switch Box but in a flame proof enclosure with ATEX, FM and IEC approvals

10. Solenoid

Optional integral pneumatic solenoid valve for actuators. Various electrical, environmental and explosion proof requirements covered.

11. Actuator

17 sizes covering torque range 0.1 Nm (1 lbf in) to 40765 Nm (356,977 lbf in). Operating air pressure range 1.4 bar (20 psi) to 7 bar (100 psi). Adjustable stops as standard. Restricted travel stops and ISO/DIN versions available.

12. 180° Converter

Compact units give constant torque output through to 200° travel.

13. Fail-Safe Spring Return Units

Clock type spring return gives reliable fail-safe operation with high torque output throughout spring stroke, yet has easy adjustment to suit application.

14. Reversible Fail-Safe Spring Return Unit

Clock type spring return unit with the ability for the direction of the spring to be reversed with only simple tools and completed in minutes - Model 07 only

15. Spring To Centre

Patented spring unit to provide accurate adjustable port travel position on loss of air/signal.

16. ISO Adaptor

The patented ISO adaptor provides easy conversion from a Kinetrol male drive to an ISO flange interface for ultimate mounting flexibility.

17. Gearbox

Geared manual override on all models from 05 to 21 excluding model 15.

18. Mounting Bracket

A comprehensive range of brackets provides for most ball, plug and butterfly valves

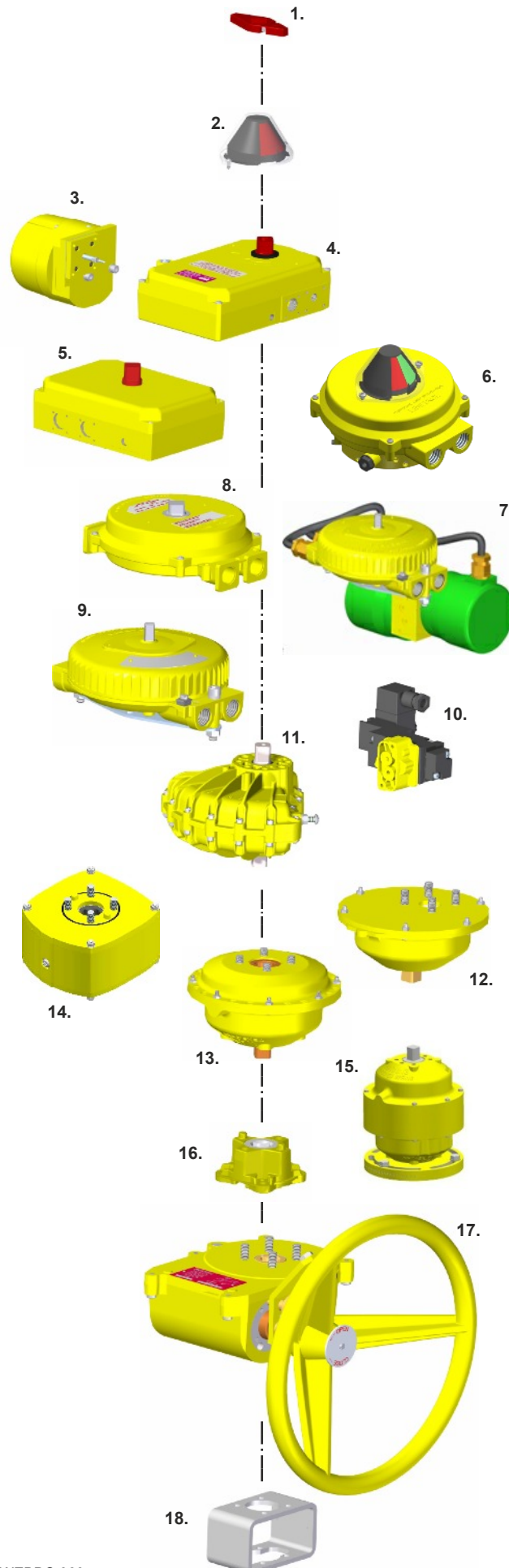

Kinetrol Control Units & Top-Mount Accessories

Models 03 & 05

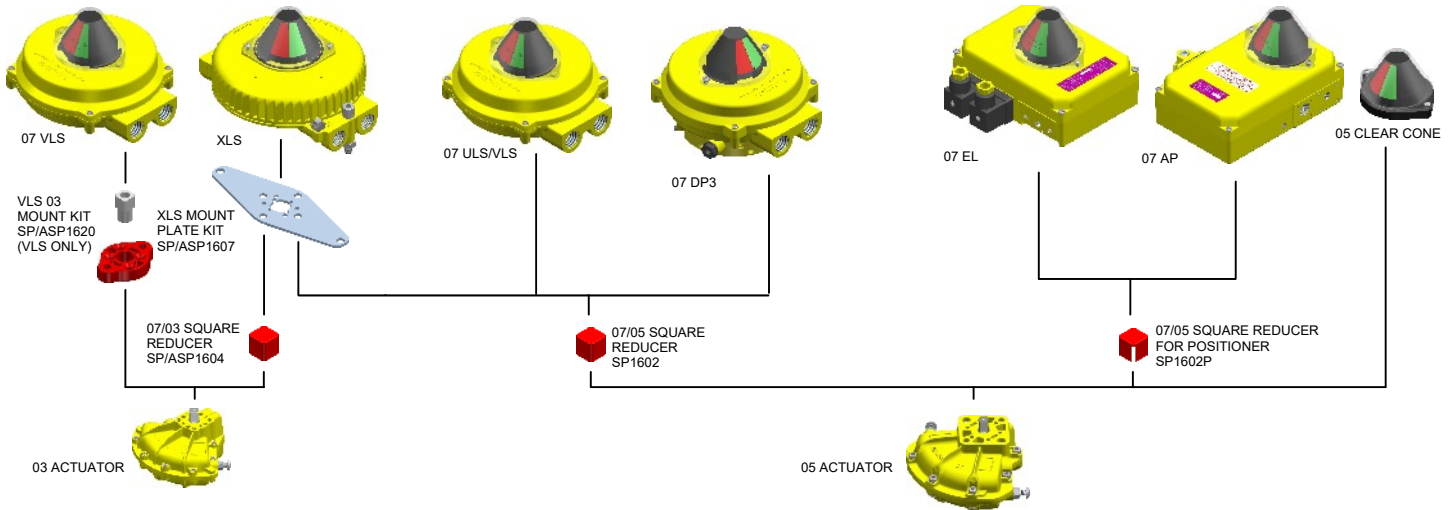

Models 07 to 15

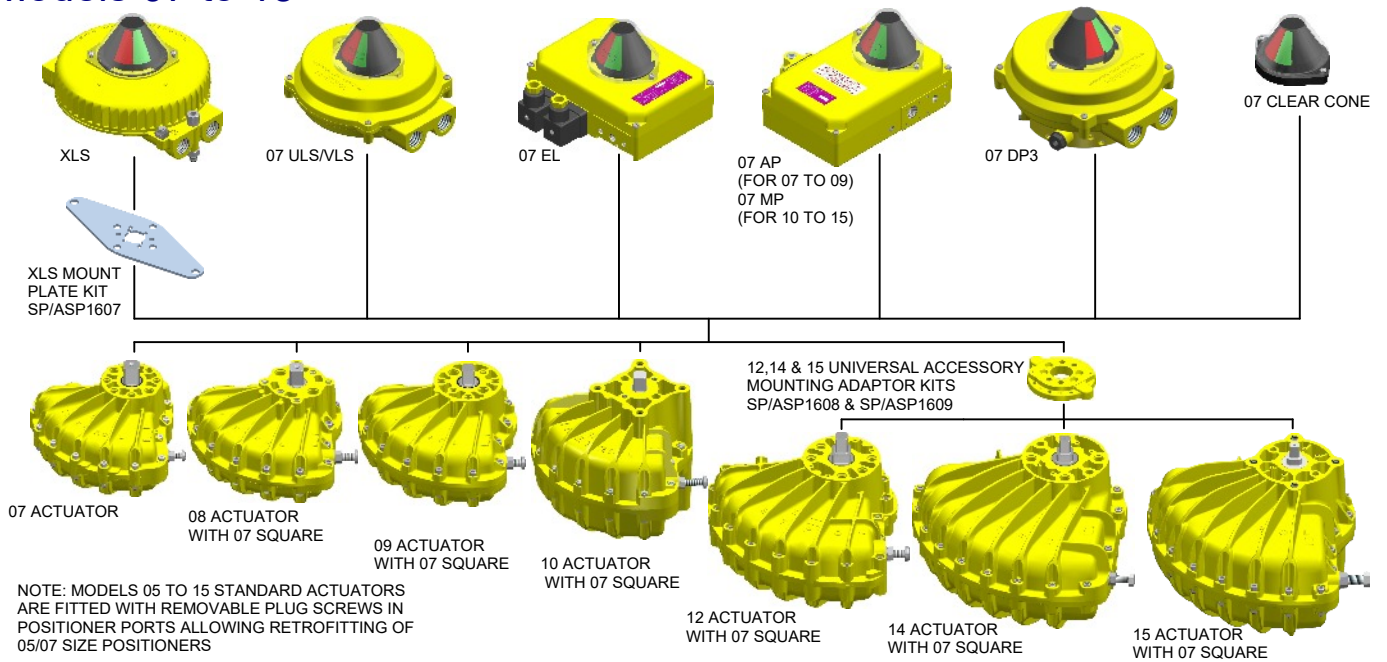

Models 16 to 60

