

700 Series Rubber Lined Valves

- Available Wafer (700G) or Lugged (704G)
- Disc and seat available in various materials to suit a wide range of applications
- Suits a range of international standard flanges including PN10, PN16 and ANSI 150lb
- Available lever, gear, pneumatic or electric operated
- Temperature range -20°C to +120°C

Features and benefits

Rib disc

The 316 stainless steel (JIS SCS14) rib disc comes standard from 50mm to 300mm. Thin profile disc reinforced by ribs (patent pending) provides larger Cv compared to our conventional design. It also reduces weight while maintaining mechanical strength. A flat face disc is also available on request.



Self-aligning stem seal through backup ring

The stem seal is the primary and secondary seal system. The backup ring functions as the self-aligning stem seal.

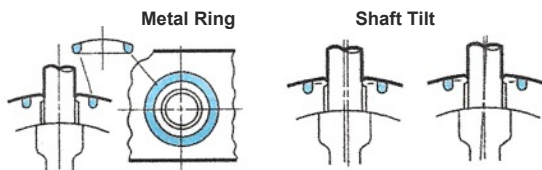

Patented cosine curve seat ring

The cosine curve seat ring reduces valve operating torque substantially and allows the torque to be adjusted according to the working pressure.

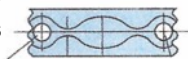

Much longer life with spherical design

Similar to a spherical body rotating inside a spherical area, the operation of the disc is smooth and unhindered. Torque is reduced and the valve life is lengthened by 300%.



KINETROL

The seat is ideally suited for use with the Kinetrol actuator which with its adjustable end stops can allow the valve to be set between 0 and 6° dependent on line pressure.

This reduces torque to operate the valve and increases significantly the life of the seat by keeping friction between the seat and disc to a minimum.



powerite
division of Kinetrol Ltd

Tel: 01902 780700
Fax: 01902 780701
Email: enquiries@powerite.co.uk
www.powerite.co.uk

Standard Specifications

Model	700G (Wafer)			704G (Fully Lugged)		
Valve nominal size	40 to 300mm	350 to 500mm	600mm	50 to 300mm	350 to 600mm	
Applicable flange standard	JIS 5K/10K, ANSI 125lb/150lb, DIN NP10, NP16 BS 4504 PN10, PN16, BS 10 'E'	JIS 5K/10K	JIS 5K, ANSI 125lb/150lb, DIN NP10, BS 4504 PN10, (excluding JIS 10K)	JIS 5K/10K, ANSI 125lb/150lb, DIN NP10, NP16, BS 4504 PN10/PN16		
Face-to-face dimensions	API 609 / ISO 5752 (20 series)					
Max. working pressure	1.0 MPa					
Body shell test (hydraulic)	1.5 MPa					
Seat leak test (pneumatic) #5	1.1 MPa					
Working temperature range #1, #2	NBR : -10 to 80 degrees C, *EPDM : -20 to 120 degrees C					
Working temperature in continuous use #3	NBR : 0 to 60 degrees C, *EPDM : 0 to 100 degrees C					
Standard materials	Body #4	Ductile iron, JIS FCD450	Cast iron, JIS FC 250	Ductile iron, JIS FCD450		
	Disc	316 stainless steel, JIS SCS14 #8	304 stainless steel, JIS SCS13 316 stainless steel, JIS SCS14	316 stainless steel, JIS SCS14 #8	304 stainless steel, JIS SCS13 316 stainless steel, JIS SCS14	
		PPS (50 to 200mm) Aluminium bronze JIS CAC702 (50 to 600mm)	Aluminium bronze JIS CAC702	PPS (50 to 200mm) Aluminium bronze JIS CAC702 (50 to 600mm)	Aluminium bronze JIS CAC702	
		Nylon coating #6	Ductile iron, JIS FCD450 with hard chrome plating	Nylon coating #6	Ductile iron, JIS FCD 450 with hard chrome plating	
	Stem	SUS420J2 / SUS 392 J1				
	Seat ring	NBR, *EPDM #7				
Actuators	Lock lever	40 to 200mm	-	50 to 200mm	-	
	Worm gear	40 to 300mm	350 to 600mm	50 to 300mm	350 to 600mm	
	Centre handle	40 to 300mm	-	50 to 300mm	-	
	Pneumatic	40 to 300mm	350 to 600mm	50 to 300mm	350 to 600mm	
	Motorised	40 to 300mm	350 to 600mm	50 to 300mm	350 to 600mm	
Coating #9	Epoxy primer finish (Munsell N7)					

- #1 Working temperature range varies depending on combination of disc materials and seating. Please consult us.
- #2 Please consult us when using NBR and EPDM seating continuously above 60 degrees C and 100 degrees C respectively.
- #3 "Working temperature in continuous use" stands for the temperature continuously kept exceeding one hour.
- #4 Cast steel body or stainless steel body is also available.
- #5 16bar finish is also available subject to working conditions.

- #6 Nylon coated disc is available from 40A to 300A. Maximum working temperature of nylon coated disc is 60 degrees C.
- #7 Heat resistant EPDM (to 150 degrees C), FPM, SEP, CR and white-NBR seats are also available.
- #8 Rib disc: standard. Flat face disc: optional.
- #9 Polyester powder backed finish (V-Pet #4000) for 700G size 40 to 300mm.
- * **Never use an EPDM rubber seat ring if the valve is being used for oil or for a fluid containing even a slight amount of oil.**

Dimensions 700G

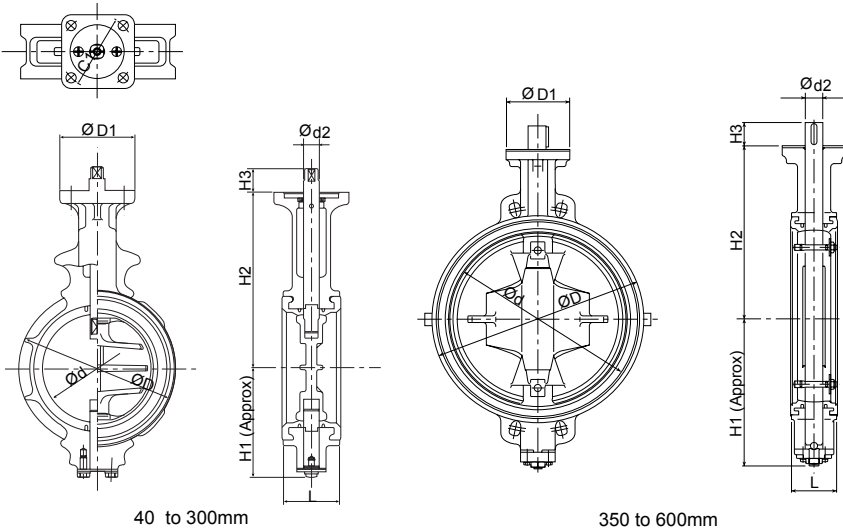

Nominal Size		Dimension (mm)								Approx Weight (kg)
mm	inch	Ød	ØD	ØD1	L	Ød2	H1	H2	H3	
40	1 ½	45	80	70	35	10	61	132	21.5	1.5
50	2	56	90	70	43	10	68	138	21.5	1.8
65	2 ½	69	115	70	46	10	79	151	21.5	2.5
80	3	84	126	70	46	12	86	156	22.5	2.6
100	4	104	146	70	52	14	103	167	22.5	3.4
125	5	130	181	102	56	16	118	191	27.5	5.4
150	6	153.5	211	102	56	18	135	202	27.5	7
200	8	199	256	102	60	22	177	227	30	10.4
250	10	253	322	102	68	28	215	280	35	18
300	12	302	367	102	78	32	253	312	35	25
350	14	337	410	140	78	32	276	348	48	42
400	16	394	469	140	102	40	338	383	54	64
450	18	441	525	140	114	46	368	413	65	87
500	20	492	580	140	127	50	403	453	79	114
600	24	584	682	165	154	55	458	528	79	191

Dimensions 704G (Fully Lugged)

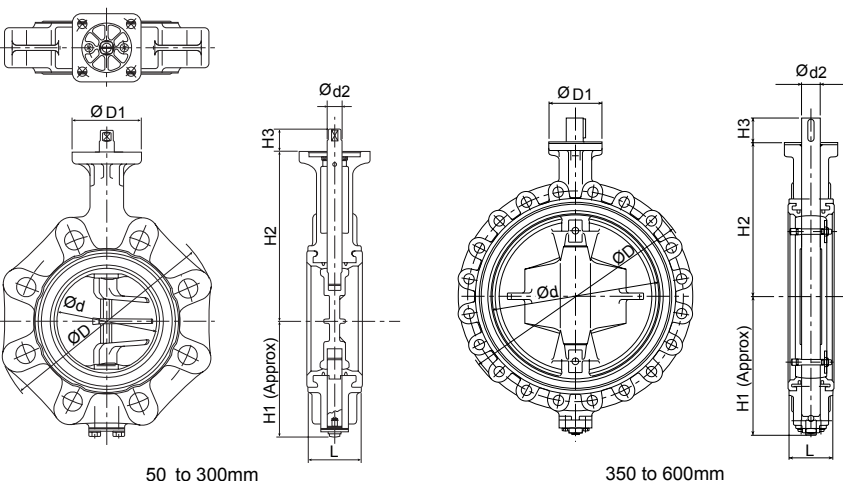

Nominal Size		Dimension (mm)								Approx Weight (kg)
mm	inch	Ød	ØD	ØD1	L	Ød2	H1	H2	H3	
50	2	56	90	70	43	10	85	138	21.5	2.5
65	2 ½	69	115	70	46	10	94	151	21.5	3.5
80	3	84	126	70	46	12	109	156	22.5	4
* 80	3	84	190	70	46	12	109	156	22.5	4.8
100	4	104	223	70	52	14	117	167	22.5	6.7
125	5	130	250	102	56	16	143	191	27.5	8.8
150	6	153.5	276	102	56	18	164	202	27.5	10.4
200	8	199	334	102	60	22	176	227	30	16.3
250	10	253	402	102	68	28	215	280	35	27
† 300	12	302	483/472	125	78	32	253	312	35	39
* 350	14	337	505/533	140	78	32	276	348	48	66
400	16	394	579	140	102	40	338	383	54	107
† 450	18	441	526	140	114	46	368	413	65	128
500	20	492	634/696	140	127	50	403	453	79	170
600	24	584	820	165	154	55	458	528	79	275
* 600	24	584	795	165	154	55	458	528	79	269

In Case JIS10K: * In Case JIS10K or DIN PN10: †